

# X-15 EXPOwire™

## Components

### PART NO./INFO:



**Part no. 5001**  
15 cm module  
Weight: 0,280 kg  
Material: Composite & alu.



**Part no. 5002**  
30 cm module  
Weight: 0,460 kg  
Material: Composite & alu.



**Part no. 5003**  
45 cm module  
Weight: 0,640 kg  
Material: Composite & alu.



**Part no. 5004**  
60 cm module  
Weight: 0,820 kg  
Material: Composite & alu.



**Part no. 5005**  
75 cm module  
Weight: 1,000 kg  
Material: Composite & alu.



**Part no. 5006**  
90 cm module  
Weight: 1,120 kg  
Material: Composite & alu.



**Part no. 5007**  
105 cm module  
Weight: 1,360 kg  
Material: Composite & alu.



**Part no. 5008**  
120 cm module  
Weight: 1,540 kg  
Material: Composite & alu.

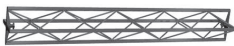

**Part no. 5009**  
135 cm module  
Weight: 1,720 kg  
Material: Composite & alu.

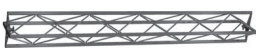

**Part no. 5010**  
150 cm module  
Weight: 1,900 kg  
Material: Composite & alu.

### PART NO./INFO:



**Part no. 5011**  
165 cm module  
Weight: 2,080 kg  
Material: Composite & alu.

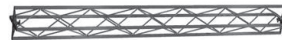

**Part no. 5012**  
180 cm module  
Weight: 2,260 kg  
Material: Composite & alu.



**Part no. 5013**  
195 cm module  
Weight: 2,440 kg  
Material: Composite & alu.



**Part no. 5014**  
210 cm module  
Weight: 2,620 kg  
Material: Composite & alu.



**Part no. 5015**  
225 cm module  
Weight: 2,800 kg  
Material: Composite & alu.



**Part no. 5016**  
240 cm module  
Weight: 2,980 kg  
Material: Composite and alu.



**Part no. 5022**  
Cube  
Weight: 0,600 kg  
Material: Composite and steel



**Part no. 5021**  
Connector  
Weight: 0,050 kg  
Material: Composite and steel



**Part no. 5023**  
Hinge 30-230 deg  
Weight: 0,600 kg  
Material: Composite & steel



**Part no. 5024**  
Connector 45 deg.  
Weight: 0,400 kg  
Material: Composite & steel

PART NO./INFO:



**Part no. 5025**  
Reinforcement  
Weight: 0,350 kg  
Material: Steel



**Part no. 5031**  
Foot 15 x 15 cm  
Weight: 0,200 kg  
Material: PEHD

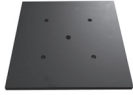

**Part no. 5032**  
Foot 30 x 30 cm  
Weight: 0,850 kg  
Material: PEHD

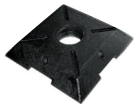

**Part no. 5033**  
Foot 40 x 40 cm  
Weight: 8 kg  
Material: Metal reinforced PEHD



**Part no. 5034**  
Foot 15 x 60 cm  
Weight: 0,650 kg  
Material: PEHD



**Part no. 5035**  
Foot 15 x 40 cm  
Weight: 0,400 kg  
Material: PEHD



without cube

**Part no. 5037**  
Foot for slabs  
Weight: 10 kg  
Material: Alu



**Part no. 5038**  
40 x 80 cm heavy base  
Weight: 26,000 kg  
Material: Metal reinforced PEHD

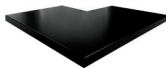

**Part no. 5050**  
L-table 45 x 45 cm  
Weight: 1,400 kg  
Material: Alu.



**Part no. 5051**  
Shelf 30 x 60 cm  
Weight: 0,900 kg  
Material: Alu.



**Part no. 5052**  
Shelf 30 x 90 cm  
Weight: 1,300 kg  
Material: Alu.



**Part no. 5053**  
Shelf 30 x 120 cm  
Weight: 1,700 kg  
Material: Alu.

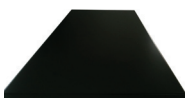

**Part no. 5054**  
Table top, 40 x 120 cm  
Weight: 2400 g  
Material: Alu.



**Part no. 5064**  
iPad holder  
Weight: 0,200 kg  
Material: Alu.

PART NO./INFO:



**Part no. 5063**  
Brochure holder - A4  
Weight: 0,450 kg  
Material: Steel



**Part no. 5062**  
Brochure holder - A5  
Weight: 0,350 kg  
Material: Alu.



**Part no. 5061**  
Brochure holder - M65  
Weight: 0,250 kg  
Material: Alu.



**Part no. 3106**  
Lamp, LED - 25W  
Weight: 0,660 kg  
Material: Various



**Part no. 4043**  
Lamp, standard - 100W  
Weight: 0,800 kg  
Material: Plastic



**Part no. 4072**  
Lamp, LED - 50 watt  
Weight: 0,600 kg  
Material: Plastic



**Part no. 4030**  
Top clips for alu list, in-door  
Weight: 0,005 kg  
Material: POM



**Part no. 4031**  
Bottom clips - for alu list, in-door  
Weight: 0,005 kg  
Material: POM & elastic



**Part no. 5073**  
Clip, full face  
Weight: 0,010 kg  
Material: POM



**Part no. 5074**  
Clip with spring  
Weight: 0,015 kg  
Material: Pom & steel



**Part no. 3045**  
Alu list - per m.  
Weight: 0,110 kg - per m.  
Material: Alu.



**Part no. 5075**  
Lamp bracket  
Weight: 0,030 kg  
Material: POM



**Part no. 5076**  
LCD bracket, set of 2 pcs.  
Weight: 1,133 kg  
Material: Steel



**Part no. 5077**  
Clip on bracket  
Weight: 0,020 kg  
Material: POM

PART NO./INFO:



**Part no. 3100**  
Waterfall Bracket  
Weight: 0,8 kg  
Material: S teel



**Part no. 5078**  
M8 screw w ith o-ring  
Weight: 0,025 kg  
Material: P A6



**Part no. 5079**  
LCD Center Bracket  
Weight: 1,5 kg  
Material: S teel

PART NO./INFO:



x1 pcs.

**Part no. 5080**  
Clip for eyelets X-15  
Weight: 0,008 kg  
Material: POM & Elastic



x100 pcs.

**Part no. 5081**  
Clip for eyelets X-15 (100 pack)  
Weight: 0,800 kg  
Material: POM & Elastic